

Lighting

Linear luminaire For fluorescent lamps

GRP

6401/562-8508-15-131 Art. No. 239554



- Can be used in Ex Zones 2, 21 and 22
- Explosion-protected linear luminaire with two fluorescent lamps: 18 W, 36 W and 58 W
- Extremely robust: Impact strength rating of IK10

WebCode 6401A



The 6401 EXLUX luminaire is suited to normal indoor and outdoor lighting applications. In no time at all and with very little effort, using the accessories it can be fitted to the wall, ceiling or a pole, or alternatively, it can be suspended. The practical central lock is available with an optional switching element that disconnects the power supply at all poles when the plastic enclosure is opened. Light-weight yet strong: The high-quality workmanship makes this luminaire robust and minimises maintenance requirements.

Technical Data

Explosion Protection

Application range (zones)	2 21 22
Certificate IECEX Gas	IECEX PTB 14.0035
Certificate ATEX Gas	PTB 14 ATEX 2017
Certificate IECEX Dust	IECEX PTB 14.0035
Certificate ATEX Dust	PTB 14 ATEX 2016
Ambient temperature °C	-20 ... +50 °C
Gas explosion protection IECEX	Ex nA IIC T4 Gc
Gas explosion protection ATEX	⊕ II 3 G Ex nA IIC T4 Gc
Dust explosion protection IECEX	Ex tb IIIC T80 °C Db
Dust explosion protection ATEX	⊕ II 2 D Ex tb IIIC T80 °C Db
Dust explosion protection IECEX 2	Ex tc IIIC TT80 °C Dc
Dust Explosion Protection ATEX 2	⊕ II 3 D Ex tc IIIC TT80 °C Dc
Certificates	ATEX (PTB), IECEX (PTB)
Languages of the documentation	German English

Electrical Data

Ex version	Yes
AC rated operational voltage	220 – 240 V
Rated operational voltage AC	220 – 240 V
DC rated operational voltage	220 – 240 V
Frequency range	50 – 60 Hz
Lamp wattage	58 W

Lighting

Linear luminaire For fluorescent lamps

GRP

6401/562-8508-15-131 Art. No. 239554



Lighting Data

Number of Lamps	2
Lamp wattage	58 W
Lamp	G13 lamp base
Luminaire efficacy	0 lm/W
Luminous flux	0 lm
Colour temperature	0 K

Ambient Conditions

Ambient temperature °F	-999 - -999 °F
Min. ambient temperature	-20 °C
Max. ambient temperature	+50 °C
Ambient temperature	-20 °C ... +50 °C

Mechanical Data

Version	Standard
IP degree of prot. (IEC 60598)	IP66
Protection class	I (with inner PE connection)
Enclosure material	Polyester resin, Glass fibre reinforced
Sealing material	Silicone
Translucent cover material	Polycarbonate
Installed terminal strip	PE + N + L1 + L2 + L3
Max. solid connect. terminals	4 mm ²
Max. fine. strand. conn. term.	4 mm ²
Type of connection cable	Solid Stranded Finely stranded
Design size	6
Width	184 mm
Height	125 mm
Length	1610 mm
Impact strength (IK code)	IK10 (IEC 62262)
Enclosure colour	Light grey (RAL 7035)
Weight	7.9 kg

Components

Threaded plate	2x plastic
Ballast	ELXe
Through wiring	With 5 conductors 2.5 mm ²
Note: Through wiring	Max. 3x16 A
Drilled holes	3 x M25
Screw connections	2 x M25 Ø 7 – 17 mm
Cable entry material	Polyamide, black
Stopping plug	2 x M25 x 1.5
Stopping plug material	Polyamide, black

Lighting

Linear luminaire For fluorescent lamps

GRP

6401/562-8508-15-131 Art. No. 239554



Light Distribution Curves

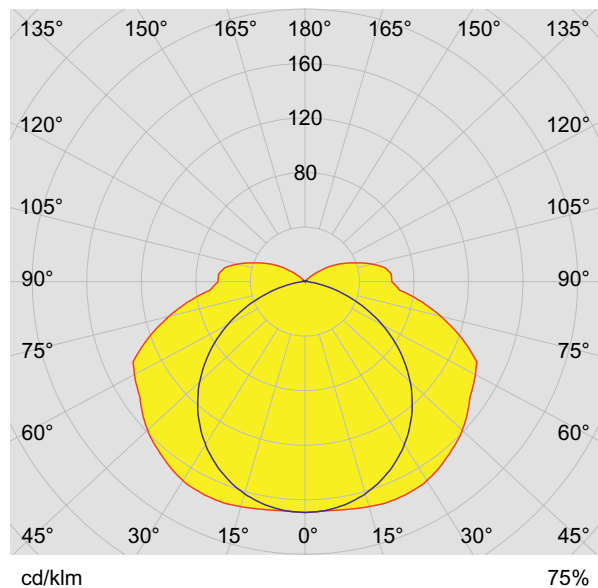

— C0 - C180 — C90 - C270

2 x 58 W

Dimensional Drawings (All Dimensions in mm [inches]) – Subject to Alterations

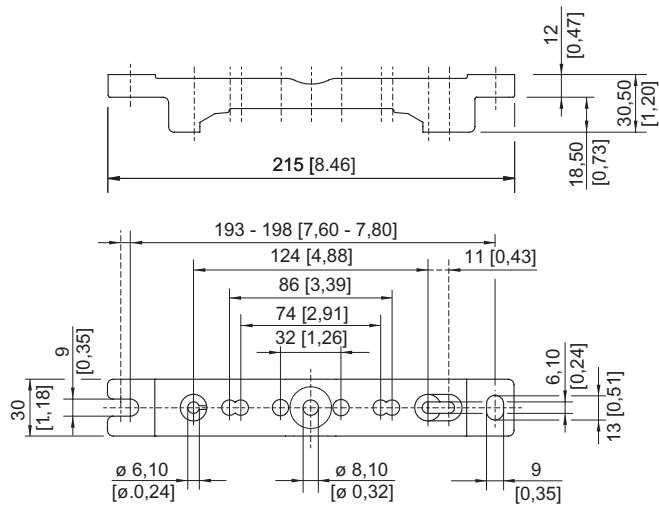

Mounting rail

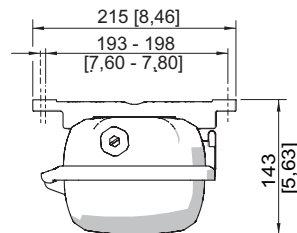

Mounting rail

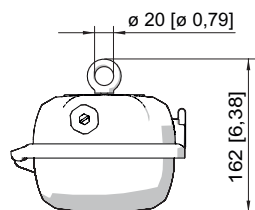

Ring bolt fitted in insert nut of the luminaire

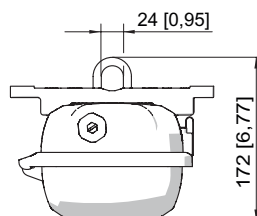

Mounting bracket fitted in mounting rail

Lighting

Linear luminaire For fluorescent lamps

GRP

6401/562-8508-15-131 Art. No. 239554

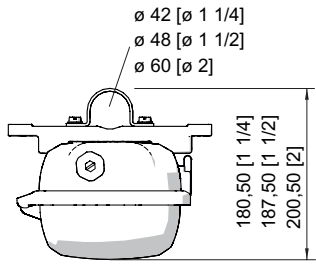

Pipe clamp fitted in mounting rail

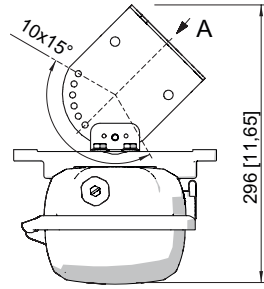

A

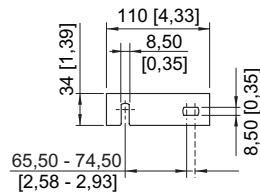

Wall mounting bracket fitted in mounting rail

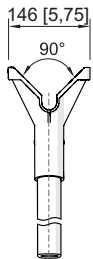
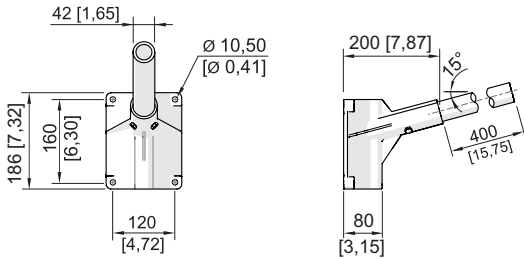

Bracket for wall mounting with pipe section

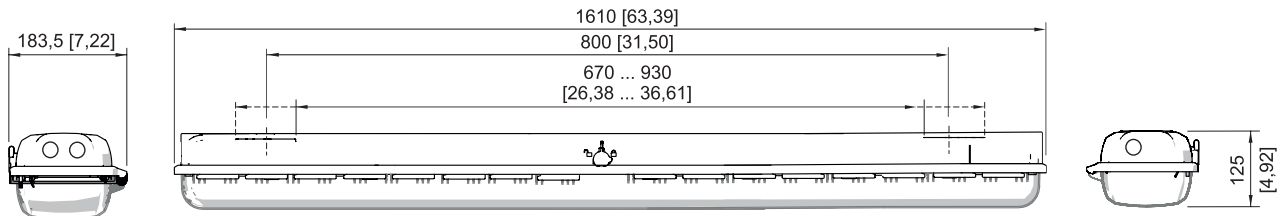

Size 6

Accessories and Spare Parts

		Art. No.
	G13 lamp holder for light fittings with T8 fluorescent lamps for use in Zone 2 and for industrial applications (x 100 units)	107275

Lighting

Linear luminaire For fluorescent lamps

GRP

6401/562-8508-15-131 Art. No. 239554



Bracket for wall mounting with tube

Art. No.

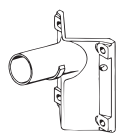

for side entry lamp; with tube, length 400 mm, d 42 mm

108947

Breather

Art. No.

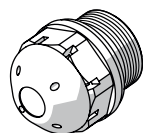

Thread: M25 x 1.5; 1 pc; for installation in lights; in moulded material; without counter nut

138573

Thread: M25 x 1.5; 20 pc; for installation in lights; in moulded material; without counter nut

138576

Ceiling and wall mounting bracket

Art. No.

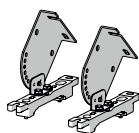

mounted on a mounting rail for a variable mounting distance; Material: stainless steel; Lamp can be swiveled in steps of 15°; 1 pair

222827

Contact Element

Art. No.

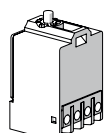

8080/1-3-L 2 NC contact element

132527

Cover

Art. No.

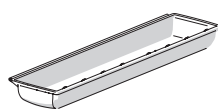

for luminaire size 6

222429

Fluorescent lamp

Art. No.

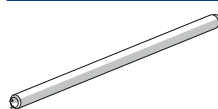

58 W, 5200 lm

108950

Mounting bracket

Art. No.

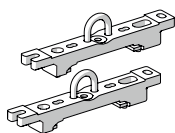

mounting clamp mounted on a mounting rail for a variable mounting distance; 1 pair

222456

Mounting rail

Art. No.

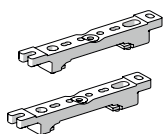

for a variable mounting distance; 1 pair

222826

Pipe clamp

Art. No.

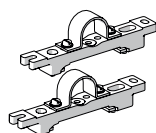

R 1 1/2"; with mounting rail for a variable mounting distance; Material: stainless steel; 1 pair

222459

R 1 1/4"; with mounting rail for a variable mounting distance; Material: stainless steel; 1 pair

222458

R 2"; with mounting rail for a variable mounting distance; Material: stainless steel; 1 pair

222460

Lighting

Linear luminaire For fluorescent lamps

GRP

6401/562-8508-15-131 Art. No. 239554



Pole mounting sleeve

Art. No.

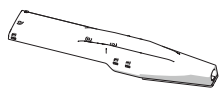

for the subsequent mounting on lights 18 W and 36 W, completely with assembly parts

227512

Ring bolt

Art. No.



M8, direct mounting in insert nuts; 1 pair

115736

Socket Key

Art. No.

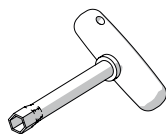

M8 / wrench size 13;
to open/close the central locking

222430

Cover

Art. No.

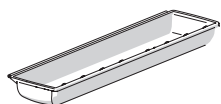

for luminaire size 6 (resistant to aromatic substances)

256536

We reserve the right to make alterations to the technical data, dimensions, weights, designs and products available without notice. The illustrations cannot be considered binding.